

# For Enrolled Students Only



## How To Purchase Course Extension Facility on **MADE EASY** App

Dear Students,

If you have enrolled in **ESE+GATE 2025, GATE 2025, Live/JE-AE 1 Yr. Foundation Course 2024 & RRB JE 2024 (Tech + Non Tech)& (Non Tech)** course at **MADE EASY**, The enrolled students can extend their course for 30 / 60 days.

S.No	Name of the course	Extension Period	Last Date to Enroll	Fee to be paid
1.	ESE+GATE 2025	1 month	15 <sup>th</sup> January, 2026	INR 3000 + GST
2.	GATE 2025	1 month	15 <sup>th</sup> January, 2026	INR 3000 + GST

S.No	Name of the course	Extension Period	Last Date to Enroll	Fee to be paid
1.	JE-AE (1 Yr. Foundation Course 2024 & RRB JE 2024 (Tech + Non Tech))	1 month	15 <sup>th</sup> January, 2026	INR 1500 + GST
		2 months	15 <sup>th</sup> January, 2026	INR 2500 + GST

S.No	Name of the course	Extension Period	Last Date to Enroll	Fee to be paid
1.	JE-AE (1 Yr. Foundation Course 2024 & RRB JE 2024 (Only Non Tech or Only Tech))	1 month	15 <sup>th</sup> January, 2026	INR 1000 + GST
		2 months	15 <sup>th</sup> January, 2026	INR 1700 + GST

For Tech Support and General Enquiry call us at

**9021300500**

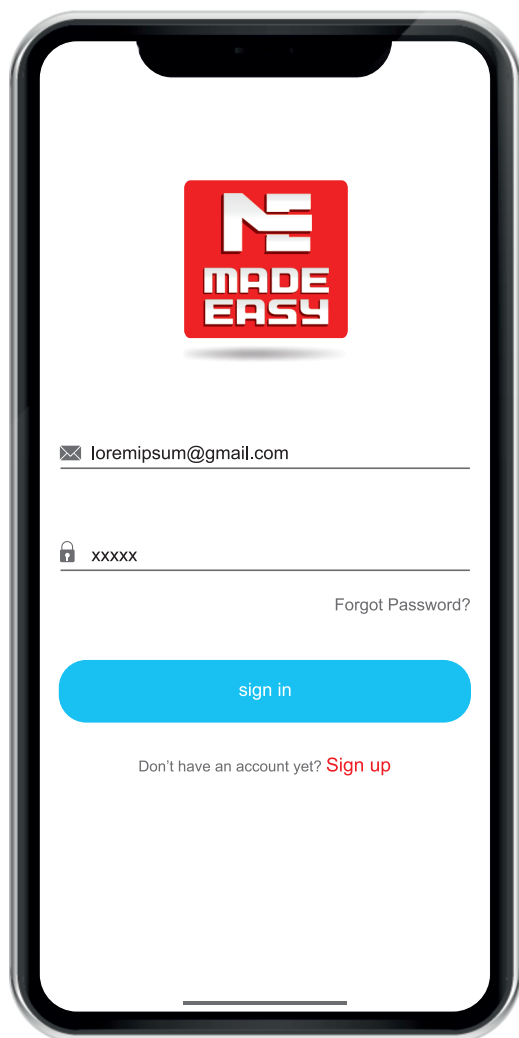

**MADE EASY**

App now available on the all three platforms



Kindly login with your user ID and password

For Tech Support and General Enquiry call us at **9021300500**

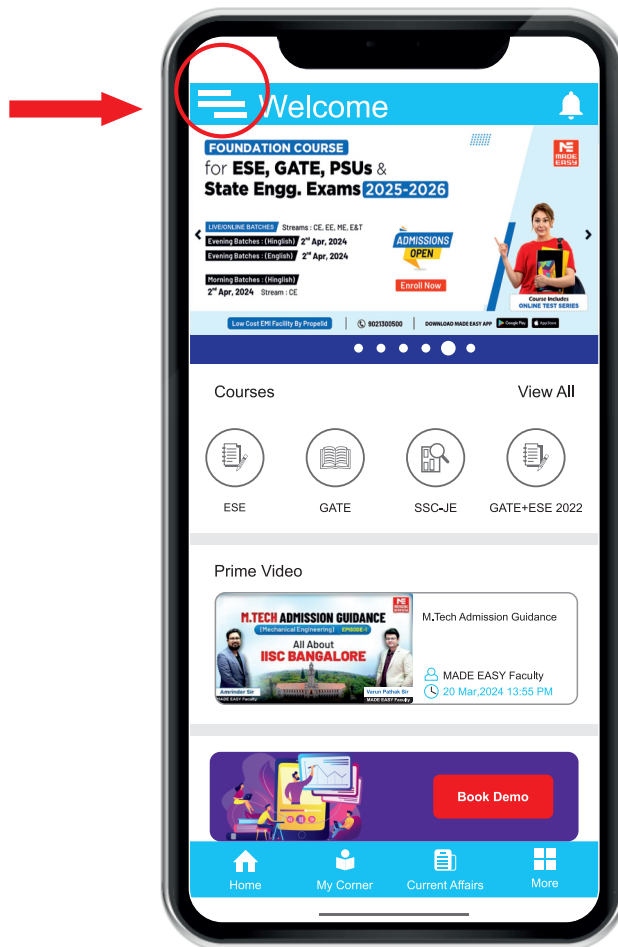

After log in on Home Page  
Click on 'Nav icon' as shown  
in circle

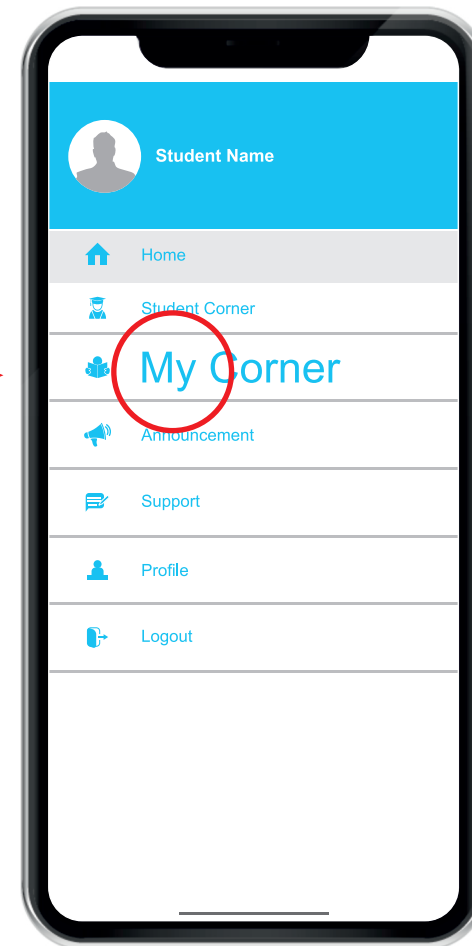

On Main Menu  
kindly click on 'My Corner'

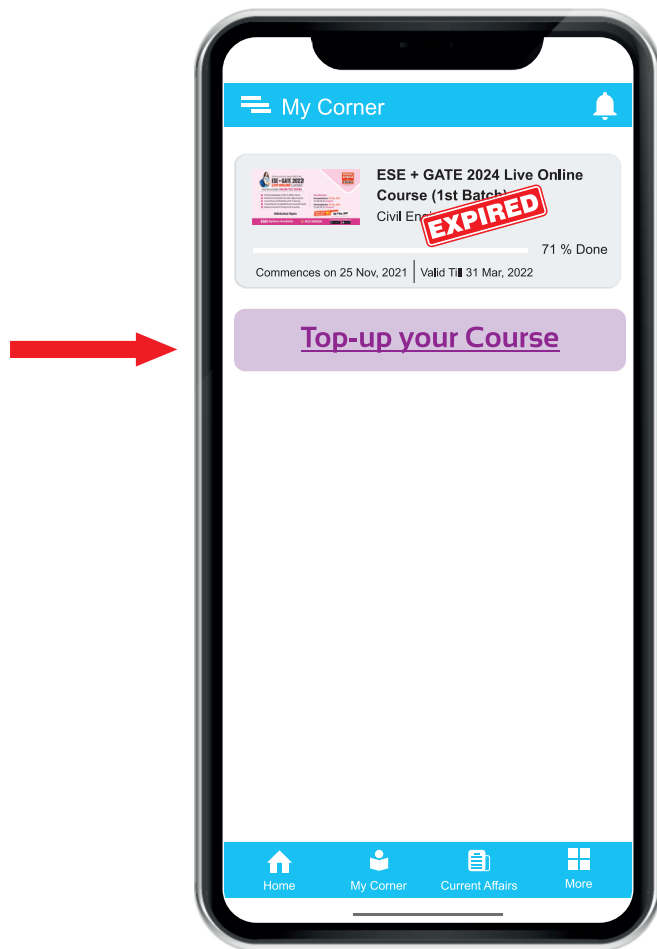

In My Corner Section  
click on Your  
'Top-up your Course'

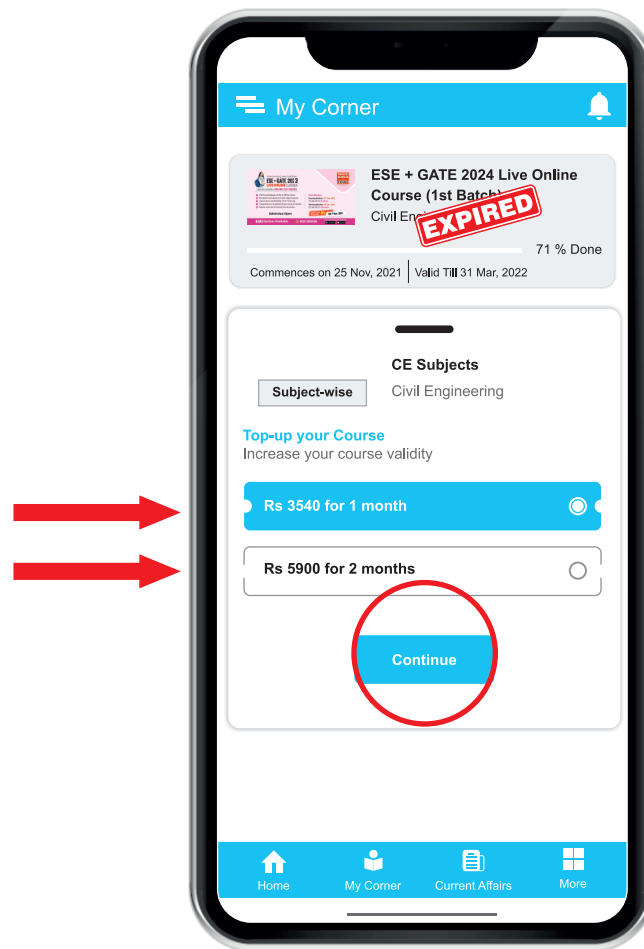

Choose your plan  
as per your requirement  
then click on 'Continue'  
Button

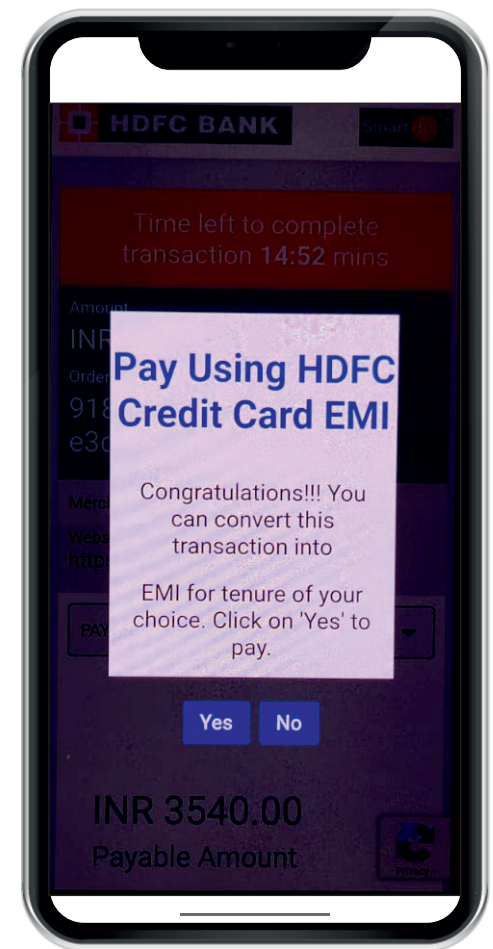

Please proceed  
for payment

For Tech Support and General Enquiry call us at **9021300500**

Thank you

**For more information kindly contact us on**

 [www.madeeasyprime.com](http://www.madeeasyprime.com)  [info@madeeasyprime.com](mailto:info@madeeasyprime.com)  9021300500